

Ora 1/8" Radius Full-Wrap Pencil Edge

## Expect More from VT Dimensions

Bring together modern style, intriguing depth, and the seamless edge you want with the beautifully contoured look of VT Dimensions countertops. Beyond the beauty, you'll have the assurance of knowing VT fabricates the whole countertop from top to bottom—not just the laminate surface—for consistent quality and service. And you get a 1-year warranty you can count on.

One source. Many beautiful looks. Only from VT.

## Specifications

- Standard substrate is 3/4" industrial-grade particleboard, available in 8', 10', and 12' lengths
- Standard postformed-grade laminate with a thickness of 0.042" + 0.002" - 0.008"
- Both standard and special styles and sizes are suitable for all residential, commercial, institutional, or light industrial applications
- Available surfaced with Formica®, Nevamar®, Pionite®, and Wilsonart® laminate
- Available as an environmentally friendly EQ countertop
- Not available surfaced with solid color laminates

# VT Dimensions

INDUSTRIES

VTDimensions.com | 1-888-287-8356  
1000 Industrial Park | P.O. Box 4901 | Holstein, IA 51025

©2015 VT Industries, Inc. All rights reserved.  
NPOA 0615



Edge: Ora

Laminate: Walnut Heights

Wilsonart® 7965-12

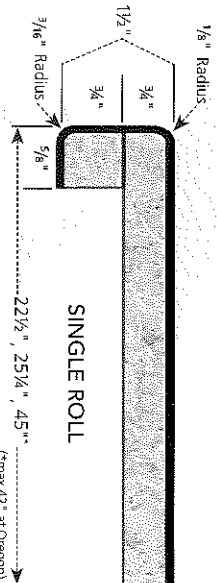
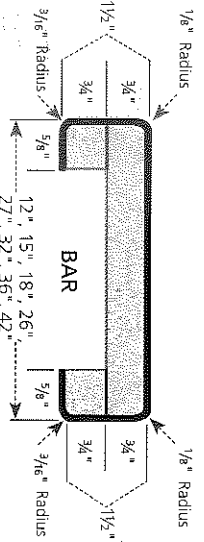
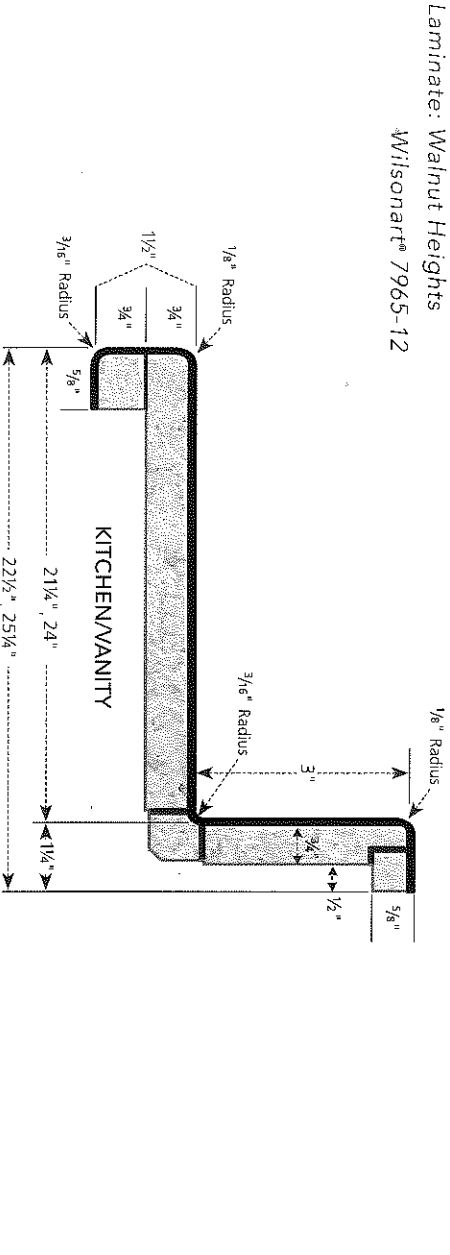

All measurements in inches. Drawings not to scale.  
(\*max 42" at Oregon)